

DH-HAC-HDW1200TRQ

2MP IR HDCVI Fixed-focal Eyeball Camera



* The parameters and datasheets below can only be applied to 1200-S6 series.

- Max. 30 fps@1080p.
- Smart IR Illumination.
- 30 m illumination distance.
- Super Adapt.
- Quick-to-install eyeball saves installation time.
- 3.6 mm fixed lens (2.8 mm optional).
- CVI/CVBS/AHD/TVI switchable.
- IP50, 12 VDC.

System Overview

The Lite Series is a great choice for consumers looking for high quality monitoring products at a reasonable price. Its low cost and high performance make it ideal for residential areas and SMB solutions. This series is equipped with a wide range of technologies, such as full-color and starlight, providing various solutions for different scenarios.

Functions

Super Adapt

With its intelligent algorithm, the camera automatically adjusts its parameters to provide optimal performance and vivid images.

Advanced 3DNR

Dahua's advanced 3DNR technology reduces image noise with little to no impact on image sharpness, especially in poor lighting conditions. It detects the noise, and compares the sequential frames to effectively reduce the noise. It also makes efficient use of bandwidth, saving on storage space.

Smart IR Illumination

With its IR illumination, the camera provides optimal performance in low light conditions, ensuring uniformity in the brightness of B/W images. Through its smart IR technology, the camera also compensates for the distance of targets by adjusting the intensity of its IR LEDs, preventing overexposure of images as targets move closer to the camera.



Easy Installation

HDCVI eyeball comes with a quick-to-install pedestal, which makes it easier to install than conventional eyeballs and reduces cost on time and labor.

4 Signals over 1 Coaxial Cable

HDCVI technology supports 4 signals (video, audio*, data and power) which are simultaneously transmitted over a coaxial cable. Dual-way data transmission allows the HDCVI camera to interact with the XVR to perform various actions such as sending control signals and triggering alarms. HDCVI technology also supports PoC, which makes the camera easy and quick to install.

* Audio input is available for select HDCVI camera models.

Long Distance Transmission

HDCVI technology provides long distance transmission in real time without transmission loss. It supports transmission distances up to 700 m for 2-MP/5-MP/8-MP HD videos through coaxial cables, and up to 300 m through UTP cables. The results were obtained and verified through rigorous testing in Dahua's test laboratory.

| Technical Specification | | | | | |
|----------------------------|--|-----------------------|----------------------|----------------------|---------------------|
| Camera | | | | | |
| Image Sensor | 2 MP CMOS | | | | |
| Max. Resolution | 1920 (H) × 1080 (V) | | | | |
| Scanning System | Progressive | | | | |
| Electronic Shutter Speed | PAL: 1/25 s~1/100000 s NTSC: 1/30 s~1/100000 s | | | | |
| Min. Illumination | 0.01 lux@F2.0 (Color, 30 IRE) 0.001 lux@F2.0 (B/W, 30 IRE) 0 lux (Illuminator on) | | | | |
| S/N Ratio | >65 dB | | | | |
| Illumination Distance | 30 m (98.43 ft) | | | | |
| Illuminator On/Off Control | Auto | | | | |
| Illuminator Number | 2 (IR light) | | | | |
| Angle Adjustment | Pan: 0°~360° Tilt: 0°~78° Rotation: 0°~360° | | | | |
| Lens | | | | | |
| Lens Type | Fixed-focal | | | | |
| Lens Mount | M12 | | | | |
| Focal Length | 2.8 mm; 3.6 mm | | | | |
| Max. Aperture | F2.0 | | | | |
| Field of View | 2.8 mm: H: 102°; V: 60°; D: 129° 3.6 mm: H: 83°; V: 48°; D: 105° | | | | |
| Iris Control | Fixed | | | | |
| Close Focus Distance | 2.8 mm: 0.5 m (1.64 ft) 3.6 mm: 0.7 m (2.30 ft) | | | | |
| DORI Distance | Lens | Detect | Observe | Recognize | Identify |
| | 2.8 mm | 41.4 m (135.83 ft) | 16.5 m (42.13 ft) | 8.3 m (27.23 ft) | 4.1 m (13.45 ft) |
| | 3.6 mm | 50.9 m (166.99 ft) | 20.3 m (66.60 ft) | 10.2 m (33.46 ft) | 5.1 m (16.73 ft) |
| Video | | | | | |
| Video Frame Rate | CVI: PAL: 1080p@25 fps; NTSC: 1080p@30 fps; AHD: PAL: 1080p@25 fps; NTSC: 1080p@30 fps; TVI: PAL: 1080p@25 fps; NTSC: 1080p@30 fps; CVBS: PAL: 960H; NTSC: 960H | | | | |
| Resolution | 1080p (1920 × 1080); 960H (960 × 576/960 × 480) | | | | |
| Day/Night | Auto(ICR)/Color/B/W | | | | |
| BLC | BLC; HLC; DWDR | | | | |
| WDR | DWDR | | | | |
| White Balance | Auto; Area white balance | | | | |
| Gain Control | Auto | | | | |
| Noise Reduction | 3D NR | | | | |
| Illumination Mode | Smart IR | | | | |
| Mirror | Yes | | | | |
| Privacy Masking | Off/On (8 areas, rectangle) | | | | |
| Certification | | | | | |
| Certifications | CE-LVD: EN 62368-1; CE-EMC: EN 55032; EN 55035; FCC: 47 CFR FCC Part 15, Subpart B | | | | |
| Port | | | | | |
| Video Output | Video output choices of CVI/TVI/AHD/CVBS by one BNC port | | | | |
| Power | | | | | |
| Power Supply | 12 VDC ± 30% | | | | |
| Power Consumption | Max 2.7 W (12 VDC, IR on) | | | | |
| Environment | | | | | |
| Operating Temperature | -40 °C to +60 °C (-40 °F to +140 °F) | | | | |
| Operating Humidity | <95% (RH), non-condensing | | | | |
| Storage Temperature | -40 °C to +60 °C (-40 °F to +140 °F) | | | | |
| Storage Humidity | <95% (RH), non-condensing | | | | |
| Structure | | | | | |
| Casing Material | Plastic | | | | |
| Product Dimensions | Φ97.1 mm × 93.0 mm (Φ3.82" × 3.66") | | | | |
| Net Weight | 0.14 kg (0.31 lb) | | | | |
| Gross Weight | 0.25 kg (0.55 lb) | | | | |
| Installation | Wall mount; ceiling mount; vertical pole mount | | | | |

Ordering Information

| Type | Model | Description |
|------------------------|--------------------|---|
| 2M Camera | DH-HAC-HDW1200TRQP | 2MP IR HDCVI Fixed-focal Eyeball Camera, PAL |
| | DH-HAC-HDW1200TRQN | 2MP IR HDCVI Fixed-focal Eyeball Camera, NTSC |
| Accessories (Optional) | PFA13G | Junction Box |
| | PFA109 | Mount Adapter |
| | PFB220C | Ceiling Mount Bracket |
| | PFB205W-E | Wall Mount Bracket |
| | PFA152-E | Pole Mount Bracket |
| | PFM800-E | 1 Channel Passive HDCVI Balun |
| | PFM321D | 12V 1A Power Adapter |
| | PFM904 | Integrated Mount Tester |

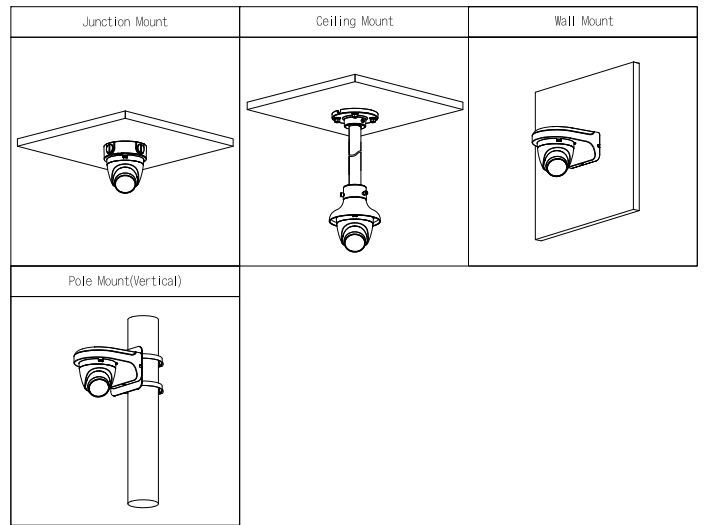

Dimensions (mm [inch])

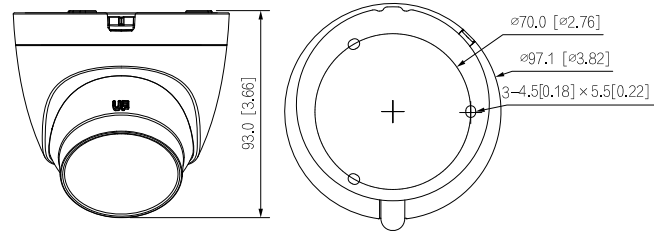

Accessories

Optional:



PFA13G
Junction
Box



PFA109
Mount
Adapter



PFB220C
Ceiling Mount
Bracket



PFB205W-E
Wall Mount
Bracket



PFA152-E
Pole Mount
Bracket



PFM800-E
1 Channel Passive
HDCVI Balun



PFM321D
12V 1A Power
Adapter



PFM904
Integrated Mount
Tester